

Federstecker, doppelt

DIN 11024

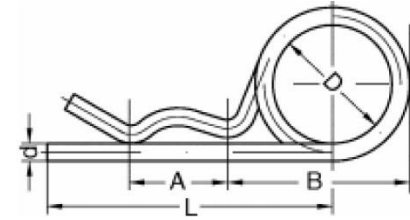

d	2,0	2,8	3,0	5,0	6,0	7,0	8,0
L	50	48	62	92	120	130	130
D	10	19	16	26	30	30	30
Lochdurchmesser	2,5	3,2	3,5	5,5	6,5	8,0	9,0
Außendurchmesser	8-14	18-22	14-20	18-30	24-36	26-40	24-40