

# Hexagonal nuts class 8

DIN 934 DIN-EN 4032

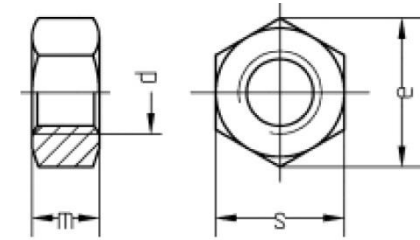

<b>d</b>	<b>M 3</b>	<b>M 4</b>	<b>M 5</b>	<b>M 6</b>	<b>M 8</b>	<b>M 10</b>	<b>M 12</b>
m	2,4	3,2	4	5	6,5	8	10
e	6,01	7,66	8,79	11,05	14,38	18,90	21,10
s	5,5	7	8	10	13	17	19